

TYPICAL SIDEWALK DETAIL
NO SCALE

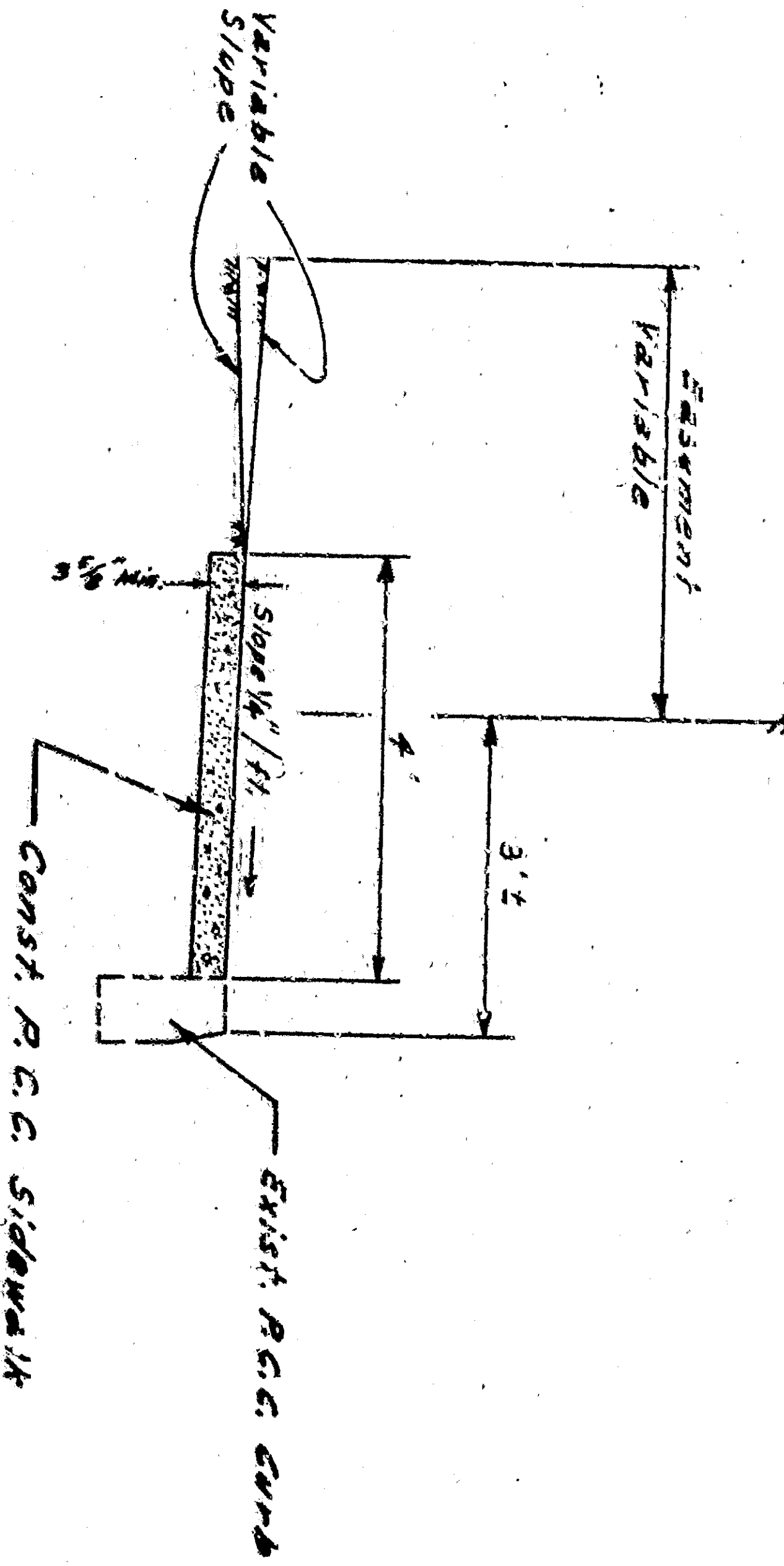

GENERAL NOTES

- All work embodied on these plans shall be done in conformity with applicable provisions of Standard Specifications No. 221, and Standard Drawing No. 231, and Special Provisions No. 228, City Of San Bernardino. Payment for all earthwork, grading, and watering shall be included in prices paid for other contract items of work and no additional compensation will be allowed therefor.
- Removal of Obstructions.
 - To be removed under this Contract.
 - To be removed or relocated by others. (Indicated by the Engineer) Bench Mark: U.S.G.S. Man. Elevation 1233.20 M.S.L. S.E. Cor. 30th St. & Waterman Ave.
- Street name signs and standard signs shall be removed and be replaced as directed by the Engineer's footings shall be placed in concrete. Existing sprinkler systems, sprinkler heads, and apparatuses in conflict with the new sidewalk shall be relocated and placed in operating condition satisfactory to the Engineer. Any new material, pipe, etc. required to accomplish the relocation shall be considered part of the relocation work.

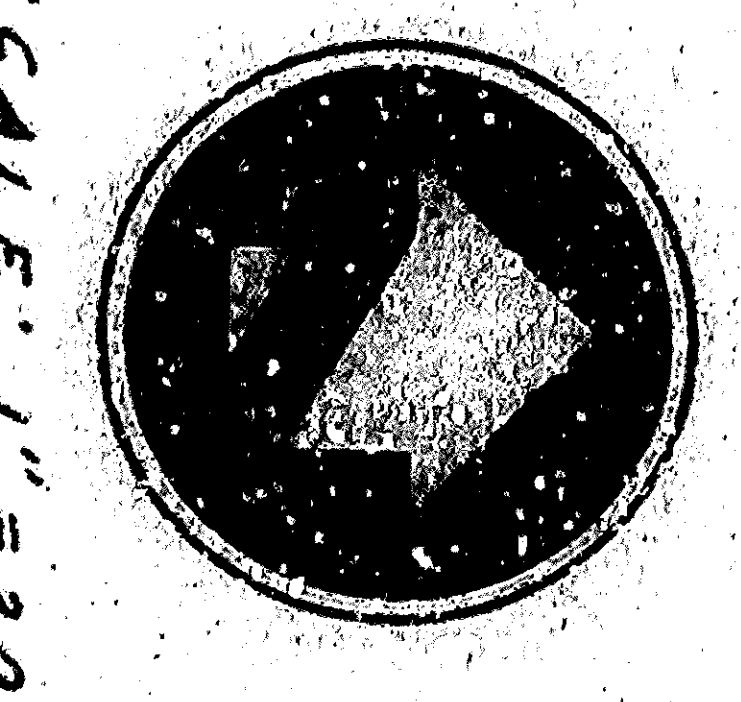
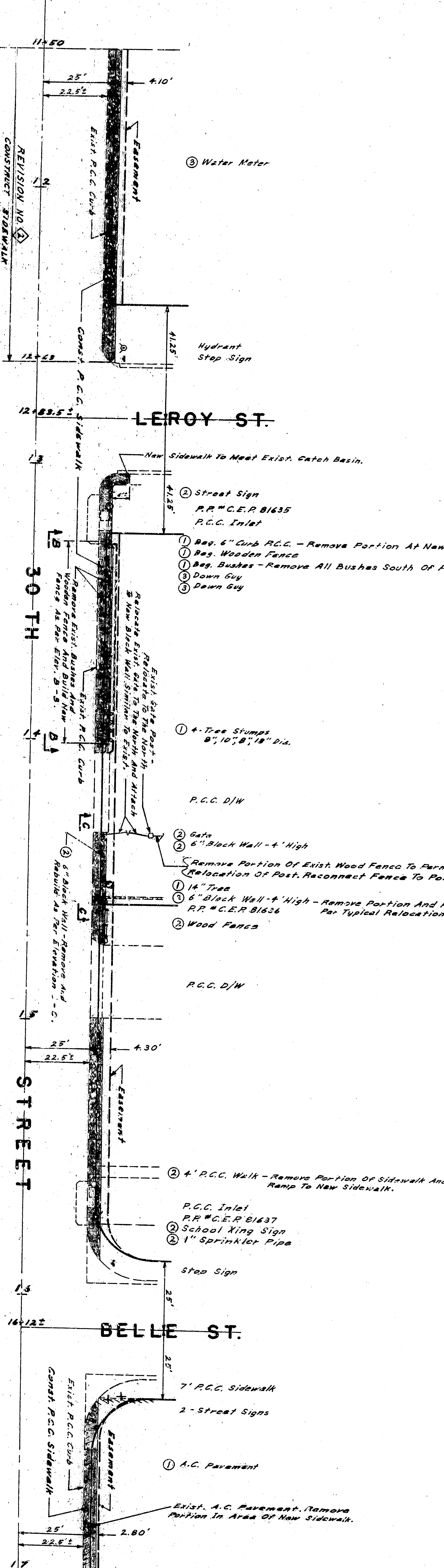

ELEVATION B-B
SCALE: 1/4\"/>

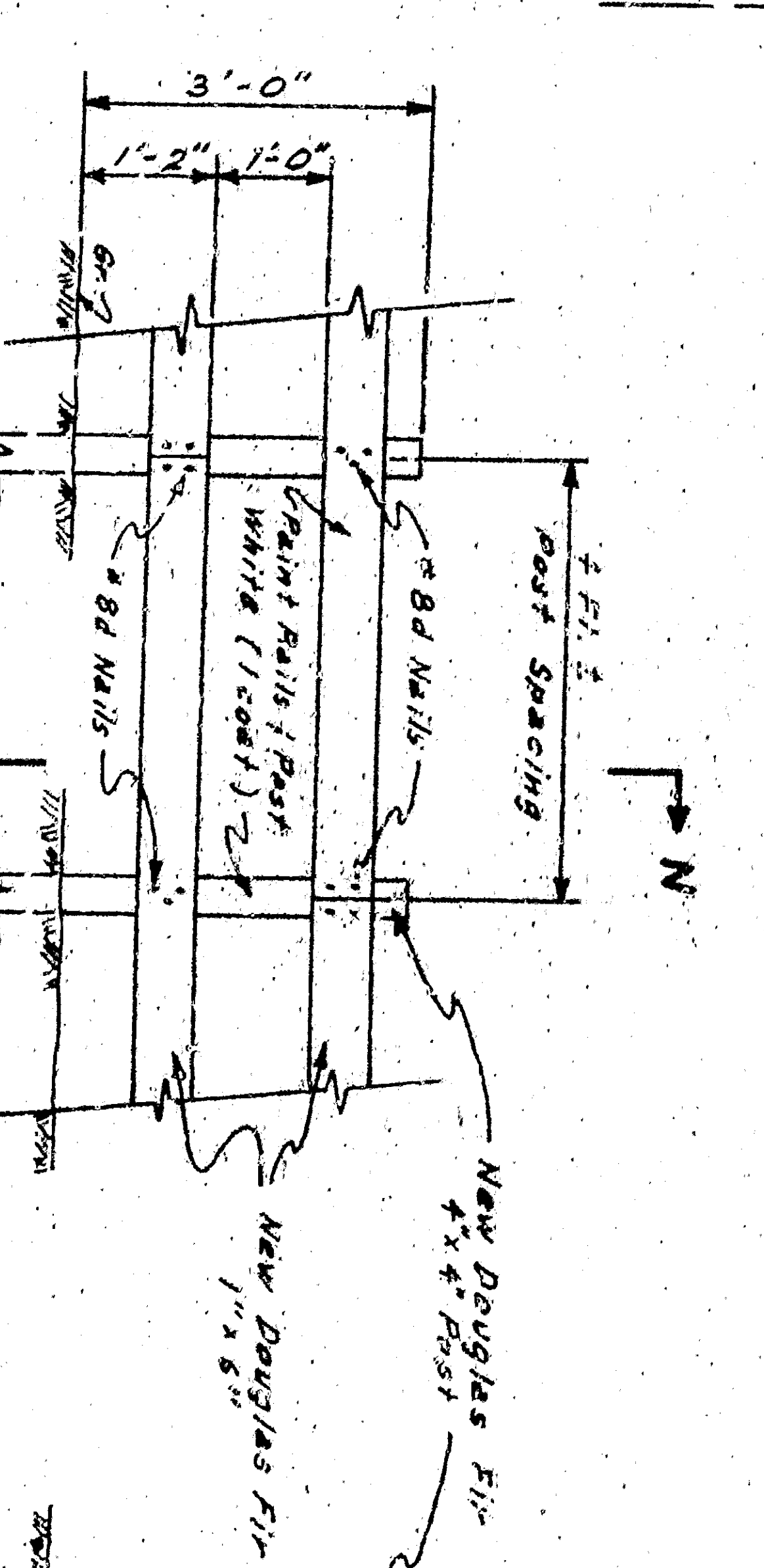

SECTION N-N
SCALE: 1/4\"/>

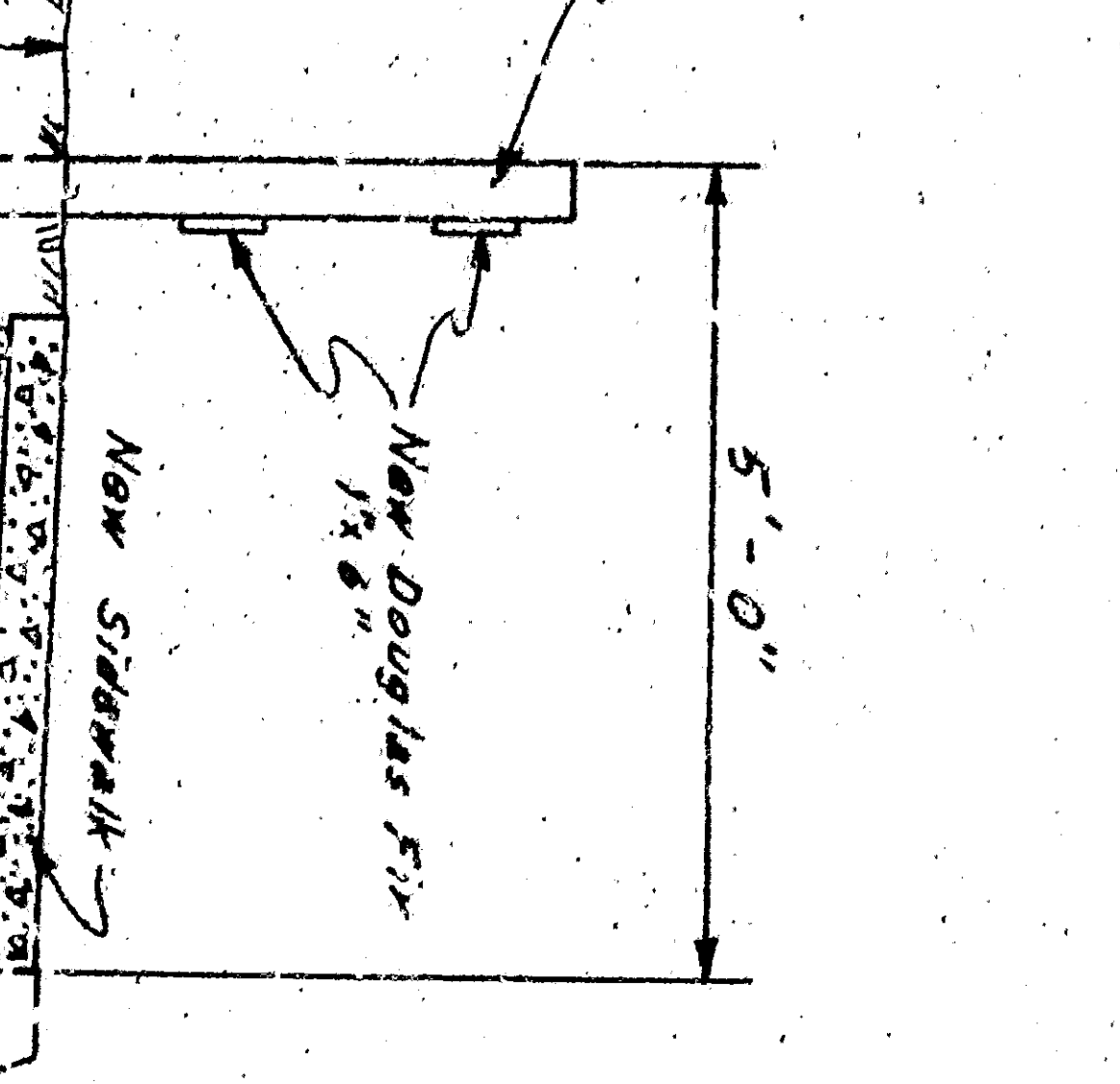

ELEVATION C-C
SCALE: 1/4\"/>

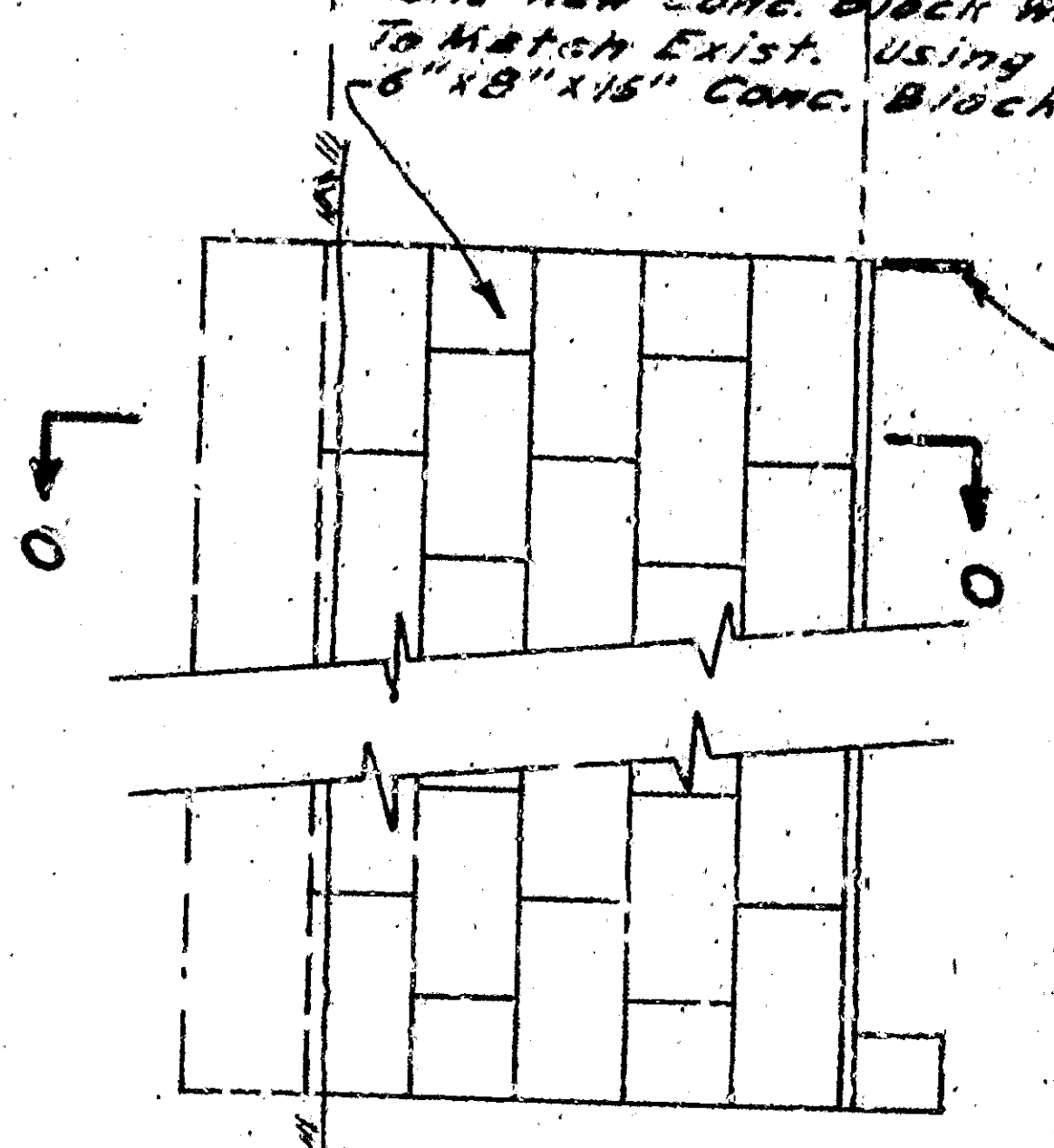

SECTION O-O
SCALE: 1/4\"/>

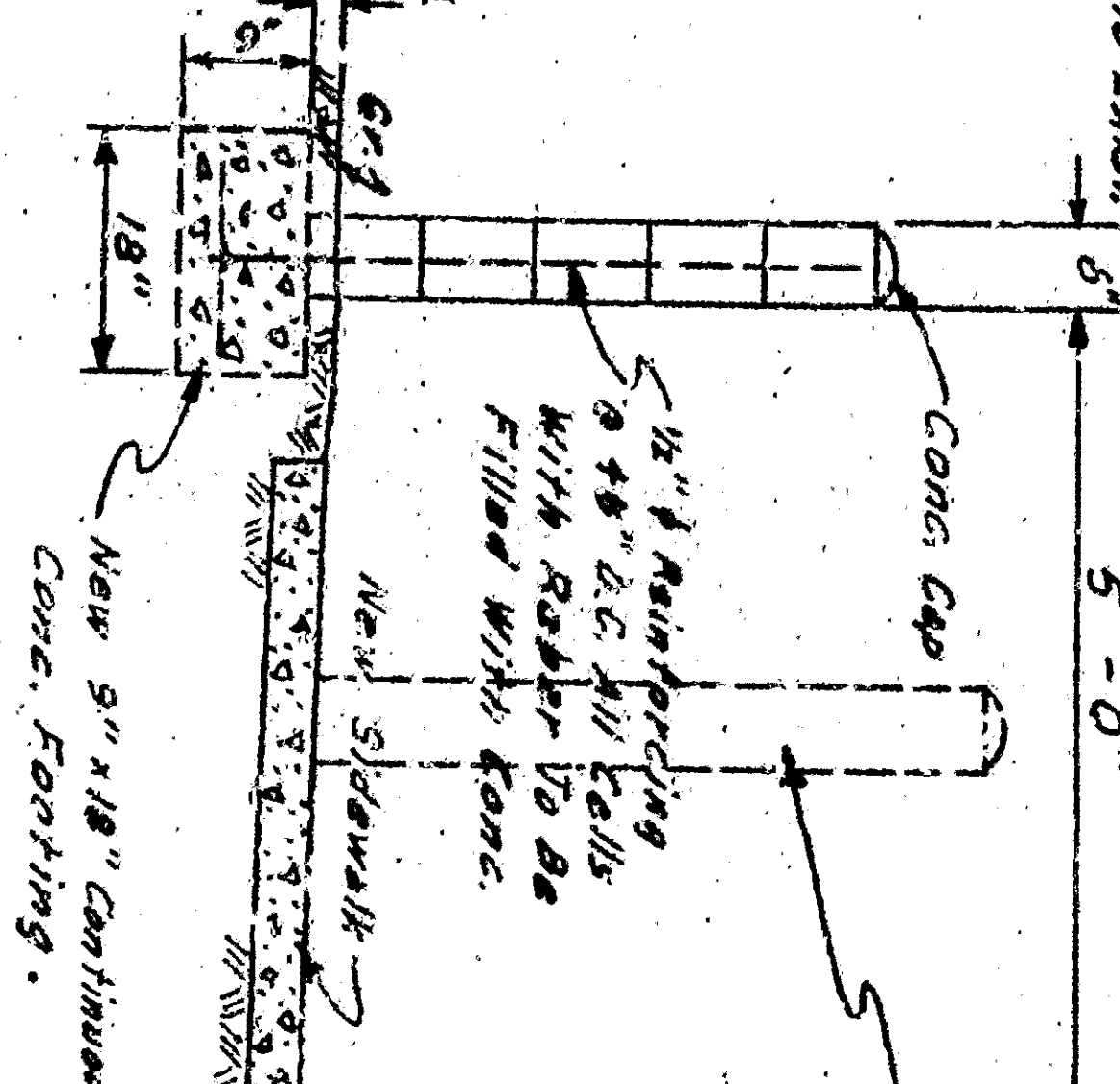

APPROVED	DATE	REVISION NO. 1 DELETED	NO.	DATE
REGISTERED CIVIL ENGINEER NO. 15523	7-2-7	DELETE SIDEWALK FROM 1024 TO 1214	1	7/2/7
DRAWN BY	CHECKED BY	APPROVED DATE		
SIERRA	SIERRA			
CITY OF SAN BERNARDINO				
DEPARTMENT OF ENGINEERING				
NORTH SIDE OF 30th STREET				
SIERRA WAY TO WATERMAN AVE.				
SIDEWALK				

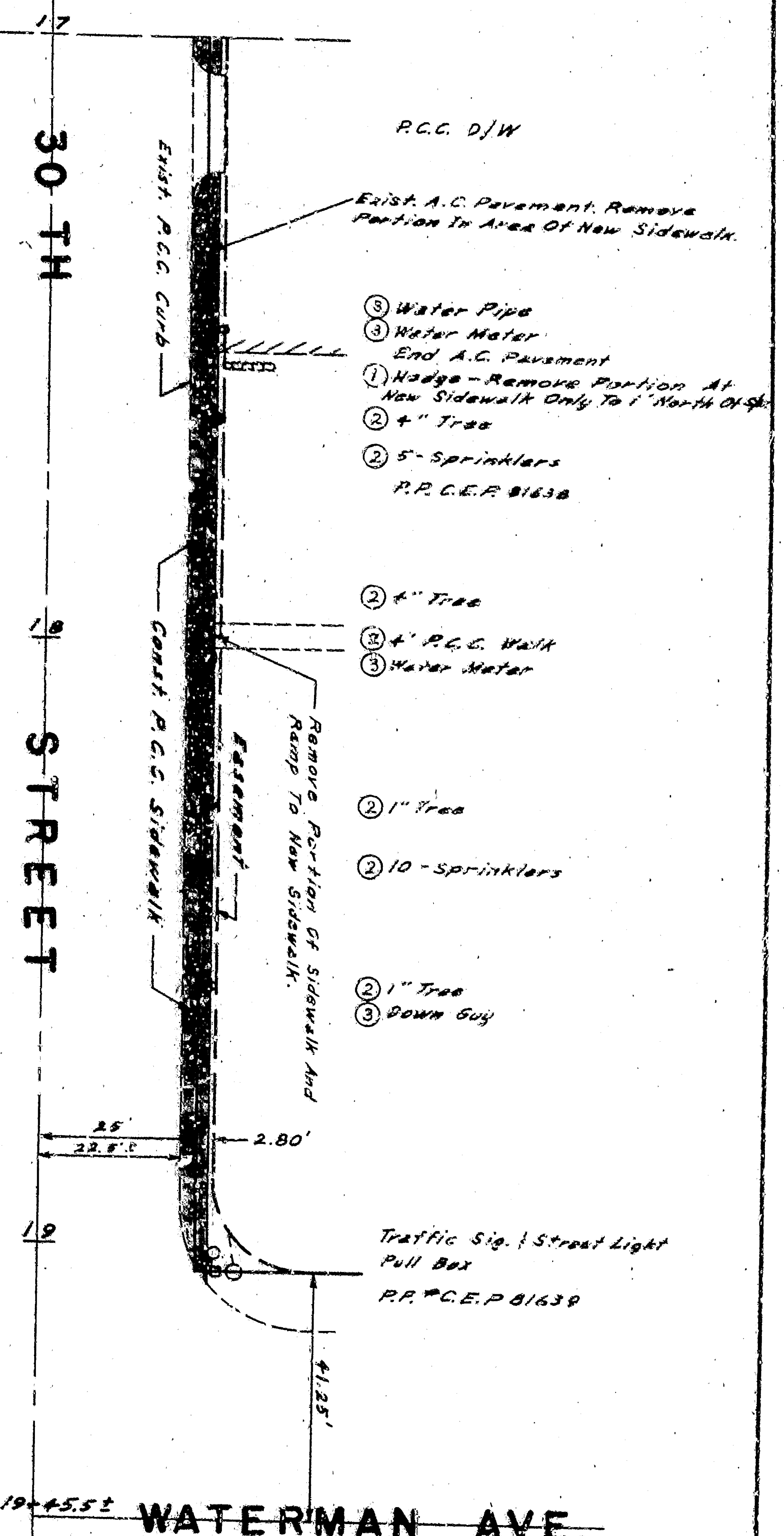

TYPICAL SIDEWALK DETAIL
NO SCALE

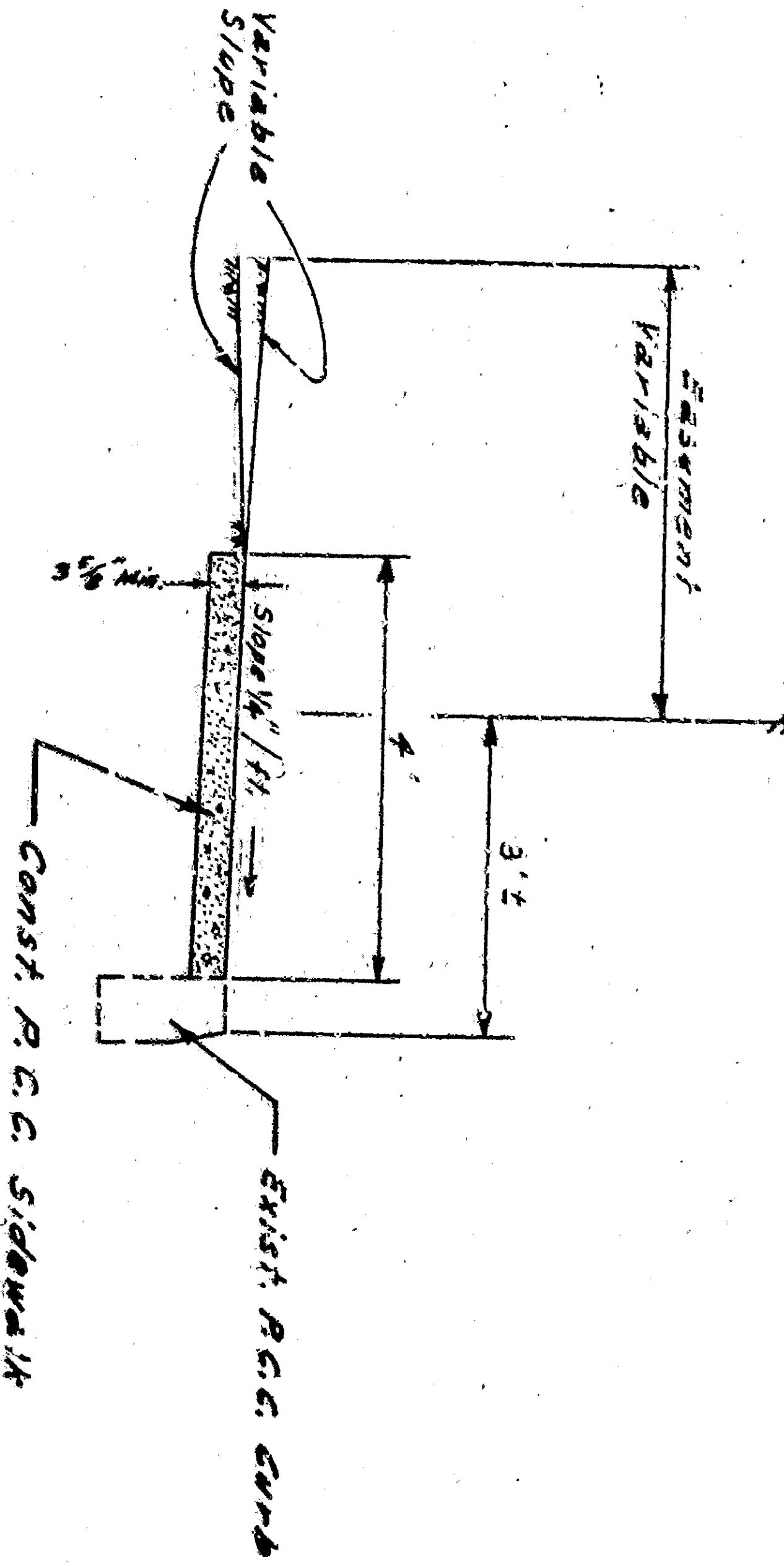

GENERAL NOTES

- All work embodied on these plans shall be done in conformity with applicable provisions of Standard Specifications No. 221, and Standard Drawing No. 231, and Special Provisions No. 228, City of San Bernardino. Payment for all earthwork, grading, and watering shall be included in prices paid for other contract items of work and no additional compensation will be allowed therefor.
- Removal of Obstructions.
 - To be removed under this contract.
 - To be removed or relocated by others. (Indicated by the Engineer) Bench Mark: U.S.G.S. Man. Elevation 1233.20 M.S.L. S.E. Cor. 30th St. & Waterman Ave.
- Street name signs and standard signs shall be removed and be replaced as directed by the Engineer's footings shall be placed in concrete. Existing sprinkler systems, sprinkler heads, and apparatuses in conflict with the new sidewalk shall be relocated and placed in operating condition satisfactory to the Engineer. Any new material, pipe, etc. required to accomplish the relocation shall be considered part of the relocation work.

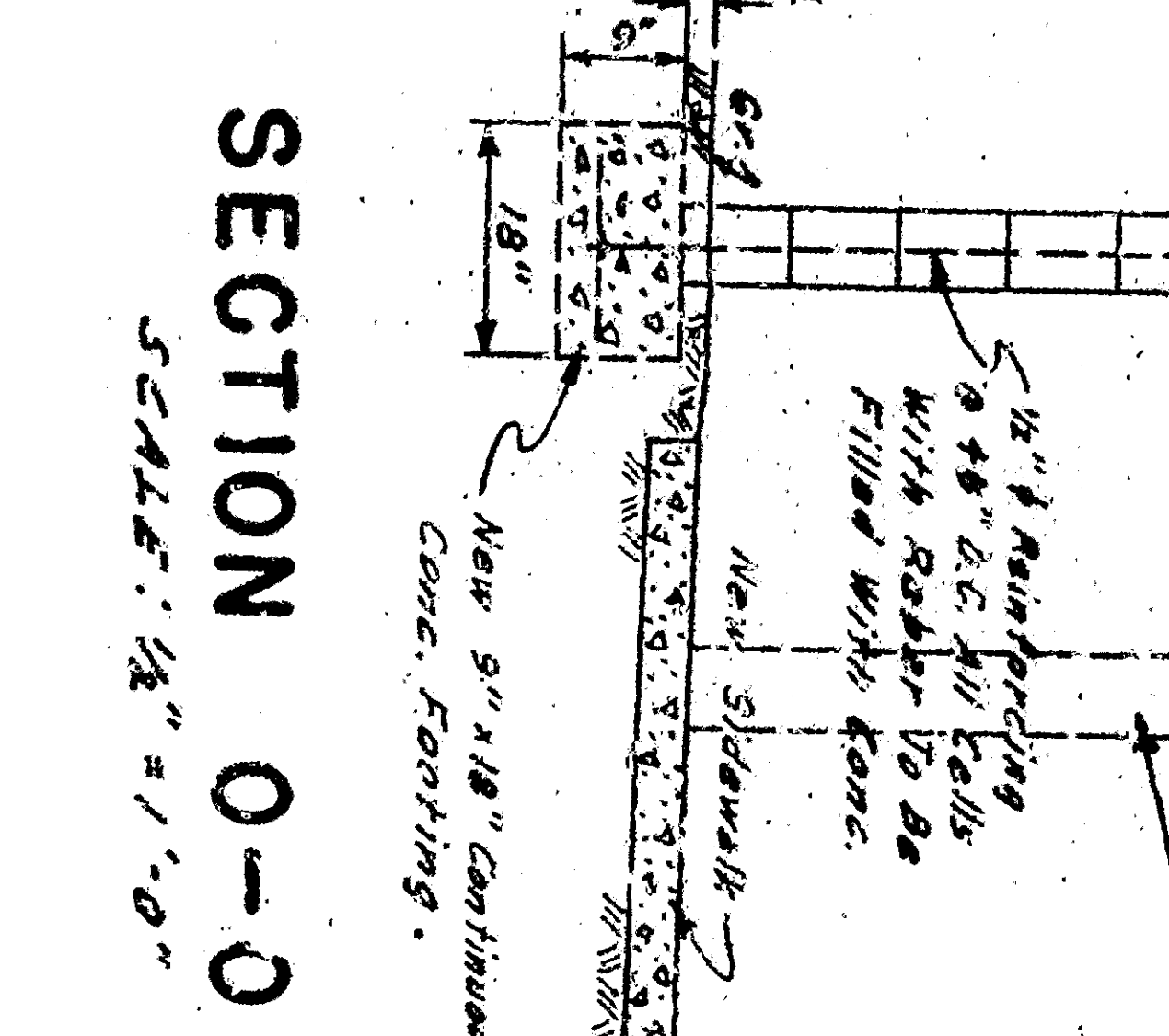
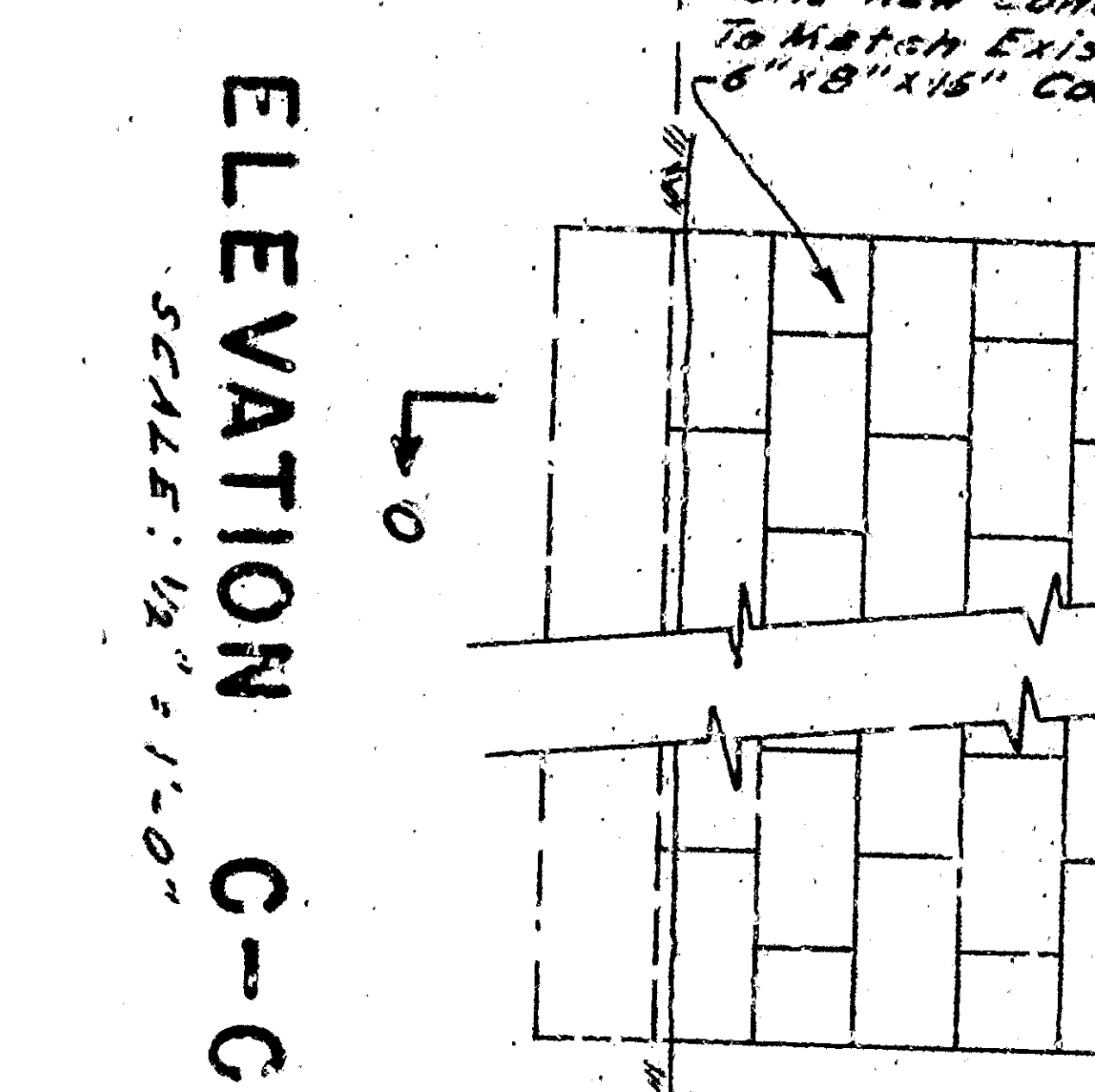
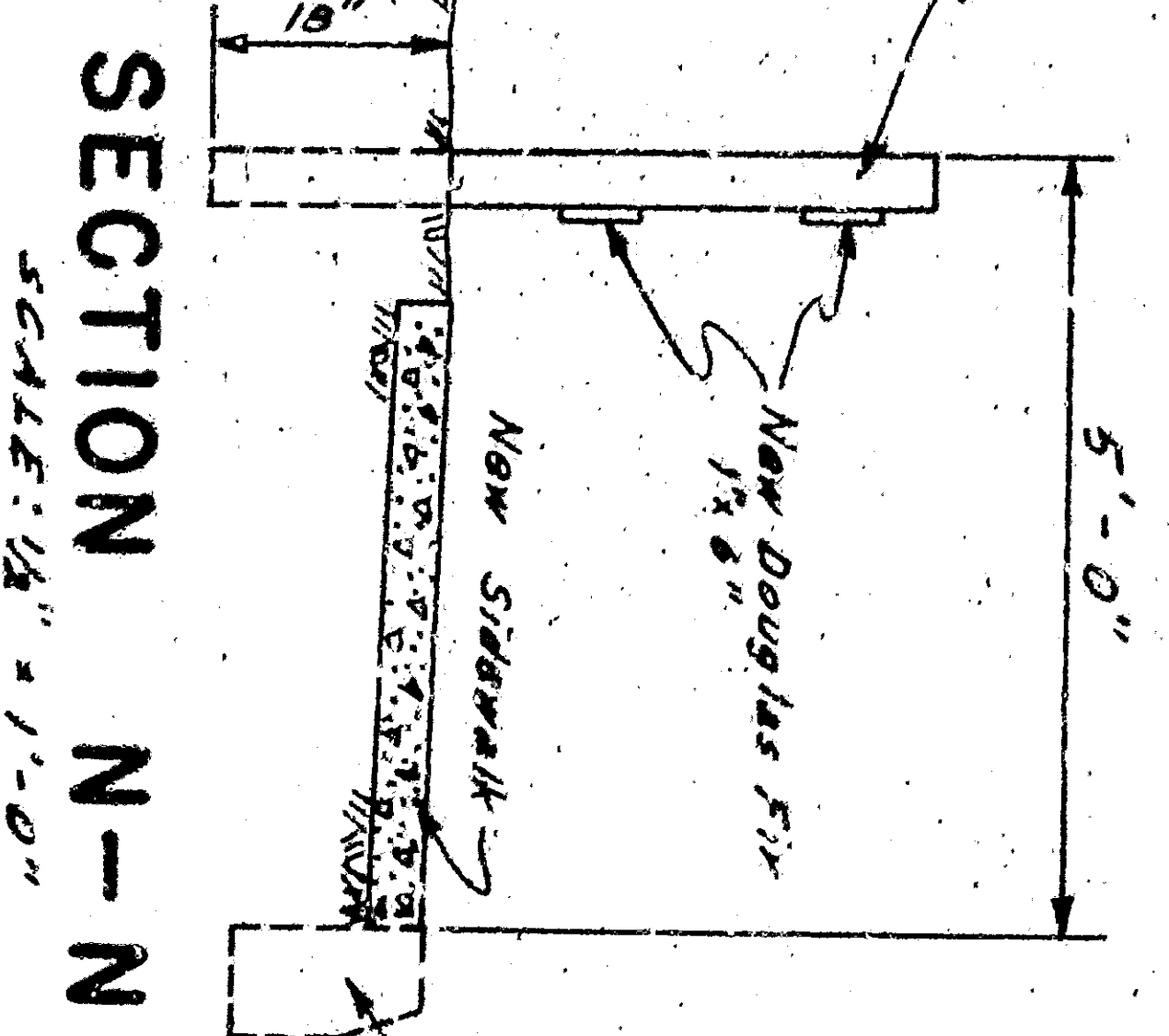
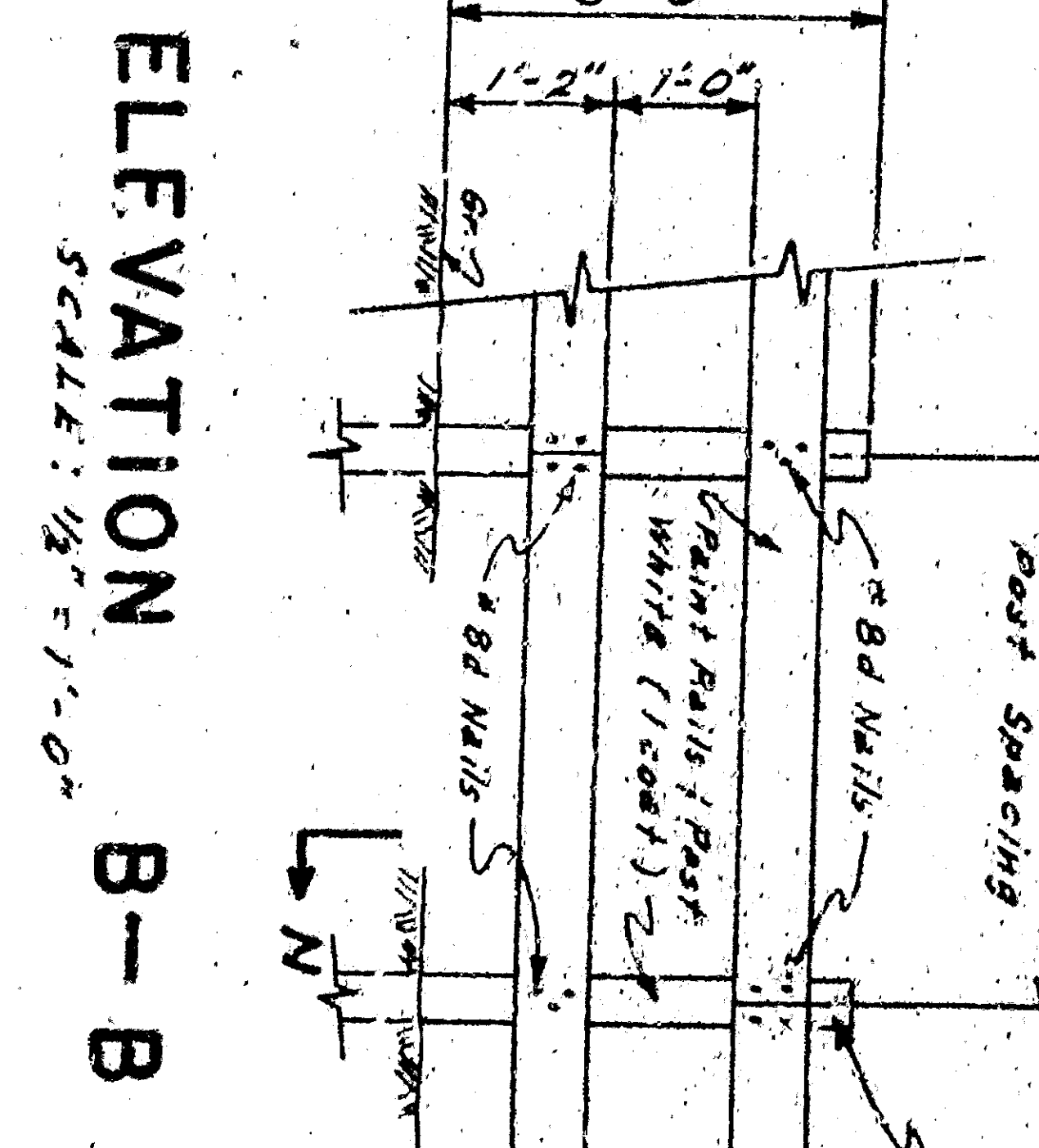
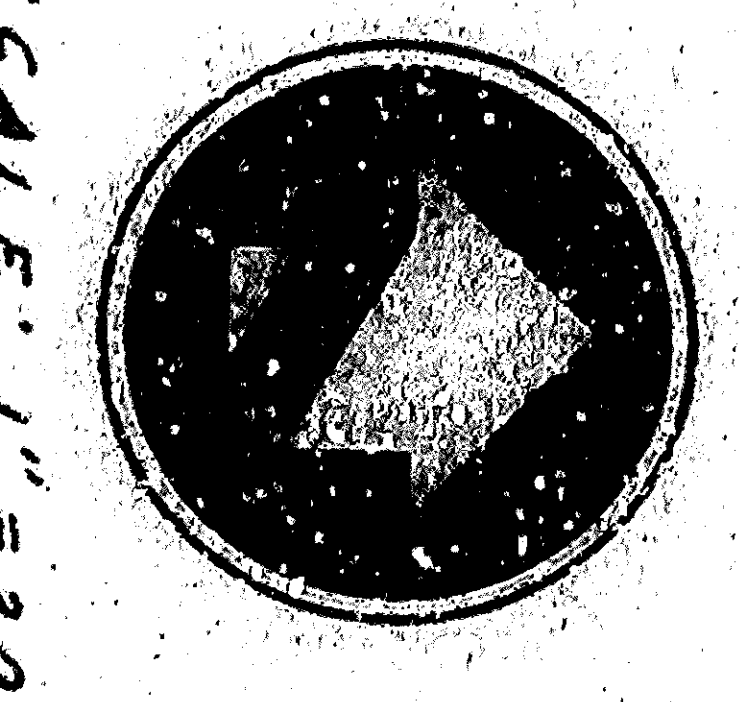
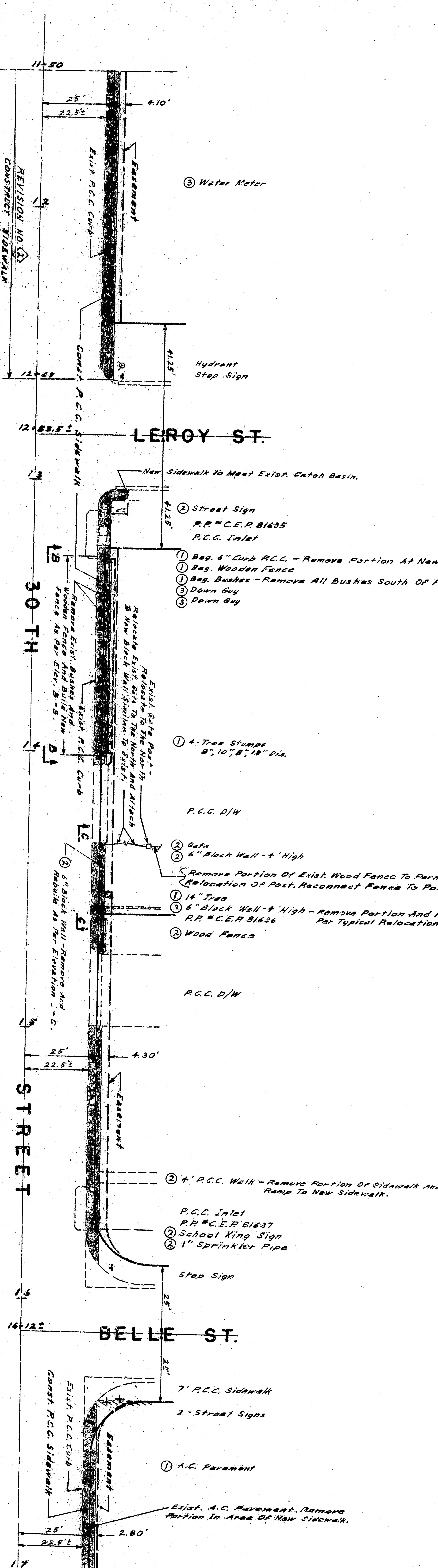

APPROVED	DATE	REVISION NO. 1 DELETED
REGISTERED CIVIL ENGINEER NO. 15523	NOV 27 1963	DELETE SIDEWALK SIGN TO STRIPES
DRAWN BY	APPROVED DATE	
CHECKED BY		
RECOMMENDED		
CITY OF SAN BERNARDINO DEPARTMENT OF ENGINEERING NORTH SIDE OF 30th STREET SIERRA WAY TO WATERMAN AVE. SIDEWALK		